



PROSCAFF NORTH AMERICA INC.

COLUMN HUNG SYSTEM - BUILD FASTER. REDUCE LABOUR COSTS.

INTRODUCTION

The Proscaff Column Hung System is saving time and money allowing you to create large tables – typically 30 ft wide by 80 feet long – using a reduced number of components.

The system is highly efficient in applications with regular floor design, bay sizes and large spans between the columns. Table sizes are adjustable and the assembly can be done by a small crew of workers.

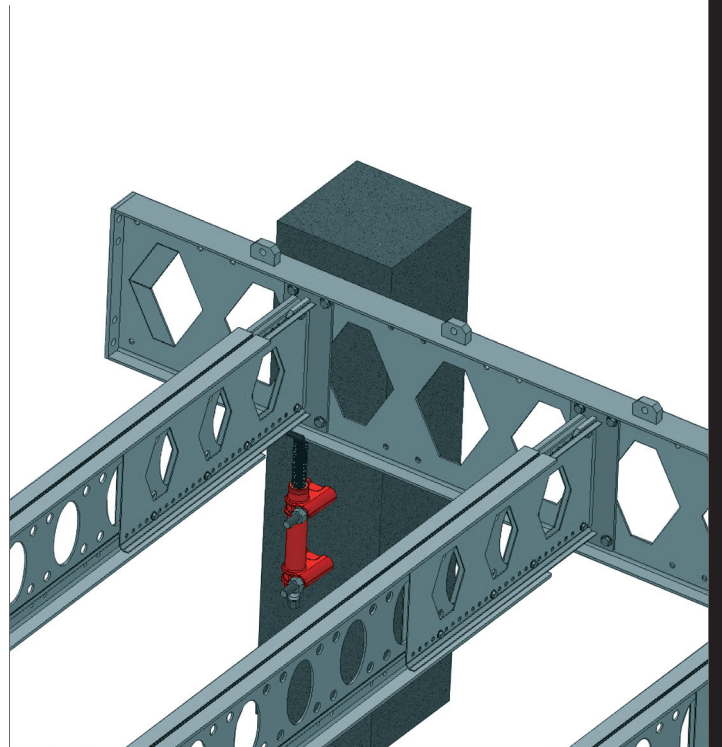

Features

The transverse beams are adjustable and various dimensions of the main beams are used.

The system reduces labor and cycle time.

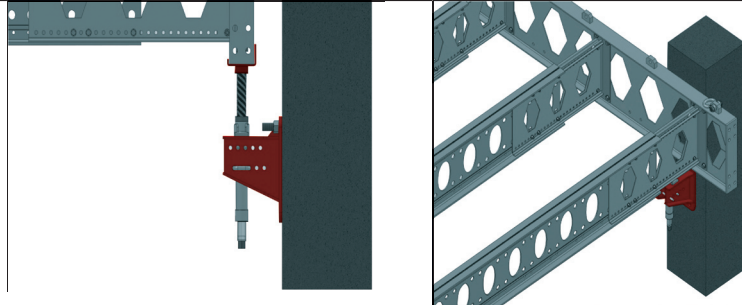

Main Components

CASTELLATED BEAM

Main beam, made of steel with a light weight design for its load carrying capacity. The hooks for lifting lugs are a design add-on, further increasing the handling speed during construction.

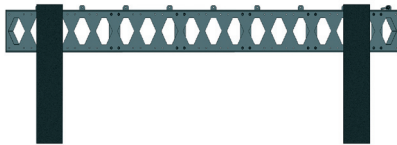

TRANSVERSE BEAM

Made of aluminum for easier handling. A steel version is available.

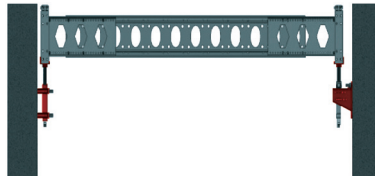

Note: The Aluminum version is showed in the models of this brochure.

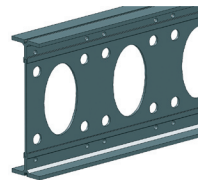

JACK BASE ASSEMBLY

This can be made available in two configurations, connected straight to the column or using a base that connects to the wall first resulting in a lighter jack.

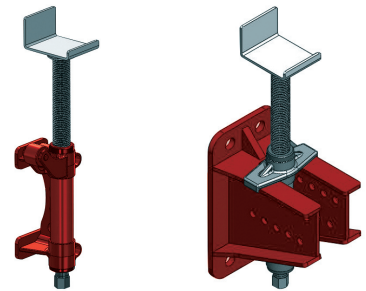

There are two configurations of jack available:

One Piece Jack:

lighter and cost effective.

Separate Jack & Base:

More versatile and faster adjustment on site

Re-shoring is unnecessary. The load is transferred, through the jack, to the column structure, rather to the floor below. Any additional work can start a few days after pouring.

OFFICE

148 Dewbourne Ave., Toronto, Ontario M6C 1Z2

[T] 416.783.7500

[F] 905 248 3172

[E] info@proscaffna.c

YARD/WAREHOUSE

1620 Claybar Rd., Ancaster, Ontario L9G 3L4

[T] 905 692 0133

[F] 905 692 2814

Heavy Duty Post Shore SGS-14K and SGS-12K

Effective & Efficient Shoring

Reach from 6'6" to 18" with 2 post shores

TALL MODEL SGS 12K FULLY RETRACTABLE & SGS 12K QUICK STRIP

Height Range: 10'-6" to 16'-0"
Load Capacity: 12,000lbs to 7500lbs

The above values are stated from minimum to maximum extension and are based on a Factor of Safety of 3:1

Adjustment Intervals

4" Fine adjustment through threaded collar, nut and 3/4" diameter G-pin or quick strip pin, depending on the model

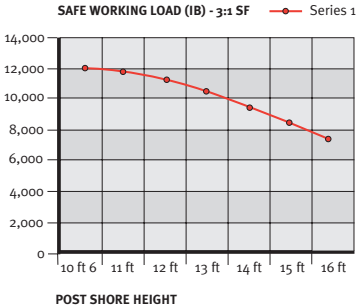
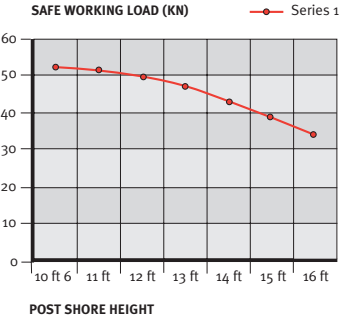

The SGS 14k and SGS 12k Advantage

- Range: 6'6" to 11'-0" and 10'6" to 16" with 2 post shores.
- Weight: 65 lbs and 79 lbs, respectively.
- Load range: 14,000 lbs to 7,500 lbs. Have 14,000 lbs capacity at 8'; 3:1 SF.
- Extension of 24" is available, making the product reach 18" high.

Unique Value and Competitive Price

- Competitive weight for the load capacity.
- Safe inner-outer tube connection - inner cannot come out on the job.
- Fully serviceable - the inner tube can be replaced.
- Re-enforced at bottom. Significant savings in repair costs.
- 130mm/5.11" fine adjustment on threaded part
- Quick strip pin - saves labor when moving from one floor to the next.
 - Average time saved in adjustments is 30 seconds/post shore. Save 50 hours for 10 floors of 600 post shores/floor.

TALL MODEL SGS 14K FULLY RETRACTABLE & SGS 14K QUICK STRIP

Height Range: 6'-6" to 11'-0"
Weight: 65 lbs
Load Capacity: 14,000lbs to 9,500 lbs

The above values are stated from minimum to maximum extension and are based on a Factor of Safety of 3:1

Adjustment Intervals

4" Fine adjustment through threaded collar, nut and 3/4" diameter G-pin or quick strip pin, depending on the model

